

# DuraBarrier™

- Sturdy single and double skin fire protection construction
- Impact resistant
- Fast & easy installation
- Seismic Resistant
- Galvanized, stainless steel & specialty metals
- For use in wind conditions up to and including category 5 hurricane areas
- Demountable for ease of equipment maintenance
- Minimize interruptions and down time during installation vs. alternate systems



PRE ENGINEERED AND MODULAR

## APPLICATIONS

- Interior and exterior transformer fire barriers
- Electrical equipment fire separations
- Protection from hydrocarbon fires and blasts
- Fire walls
- Fire and blast containment for gas storage
- Fire barriers
- Compressor protection
- Acoustical barriers
- Portable barriers
- Protection of natural gas equipment
- People and equipment protection

Recognized by FM Global as an exterior fire rated barrier system for electrical transformers.

**Albarrie Geocomposites Limited**

Tel: 705-737-0551  
Toll Free: 1-866-269-8275

[www.sorbwebplus.com](http://www.sorbwebplus.com)

Patent Pending

# DuraBarrier™

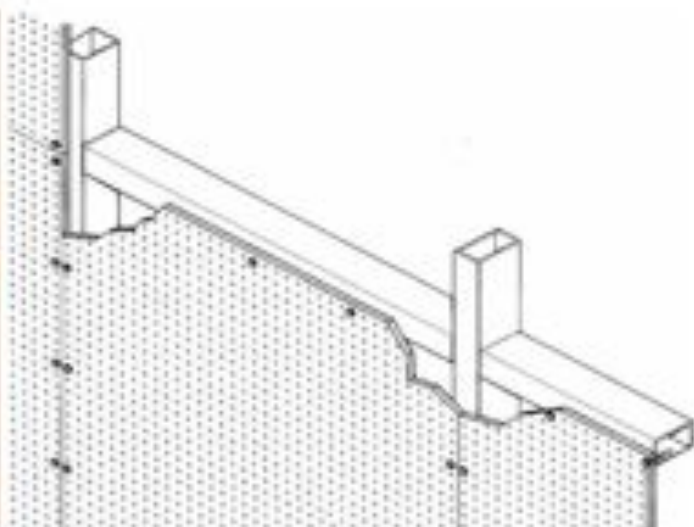

Each barrier separation is constructed utilizing a DuraBarrier modular system. Each DuraBarrier module is constructed of a DuraSteel panel comprising of two sheets of galvanized, stainless or specialty metals mechanically bonded to a fiber cement core which forms a unique non-combustible material that is **Fire, Blast, Moisture, Corrosion and Impact** resistant.

Due to their relatively low weight, DuraSystems' walls, partitions and barriers require reduced complexity and size of foundations in comparison to poured concrete or concrete block methods. This can result in significant cost savings especially when dealing with retrofit applications where existing equipment is being upgraded or replaced and/or existing underground services or foundations cannot be disturbed. Less disruption to the existing grounding grid.

With the benefit of modular construction, DuraSystems' walls, partitions, and barriers offer fast and safe original installations and allows for the future disassemble and reassembly for maintenance or replacement of the equipment protected. This benefit ensures downtime and interruptions are kept to an absolute minimum of the operating systems protected.

Although fire and blast protection is the DuraBarriers' main objective its other inherent qualities should not be overlooked. Due to its ability to provide noise reduction and be finished in multiple finishes, the DuraBarrier provides the needed qualities for any installation.

# DuraSteel™

**Description:** Durasteel, a composite panel composed of a fiber cement core mechanically bonded to pierced steel sheets on both outer surfaces

**Finish:** Durasteel comes standard with either G90 (Z275) galvanized or 316-2B stainless steel face sheets

**Statistics:** Effect of 4,000J hard body impact test after fire test to DIN 4102.....Unaffected  
Non-combustibility to BS476:Parts 4(1970) & 11(1988)....Non-combustible  
Surface spread of flame to BS476: Part 7 (1971).....Class 1  
Effect of fire on saturated construction.....Unaffected  
Sound reduction properties.....29.9 dB  
Maximum fire tested to 4 hrs.....Unaffected

### International Testing & Acceptance

UL & ULC  
FM  
LLOYDS  
LPC / FIRTO  
WARNOCK-  
HERSEY  
SWRI  
BRE



**Albarrie Geocomposites Limited**

Tel: 705-737-0551  
Toll Free: 1-866-269-8275

[www.sorbwebplus.com](http://www.sorbwebplus.com)

- Fire Resistant
- Blast Resistant
- Impact Resistant
- Moisture Resistant
- Maintenance Free
- Robust Durability
- Cost Competitive
- Up to 4 hr fire protection
- Corrosion Resistant

# DuraBarrier™



The DuraBarrier modular system is available in either structurally pre-engineered or modular sections for structural engineering by others.

The DuraSystems pre-engineering systems are available to meet the following conditions:

- Interior and Exterior installations
- Wind conditions up to and including Category 5 (42.1 psf) Hurricane
- Barrier heights up to 35 feet
- Barrier available in unlimited widths
- Available with both 90 degree and T joint connection
- Available for both continuous and pier foundation methods
- Tested up to 6 hours in the DuraBarrier configuration

If requirements for a DuraBarrier are not met by the above standard conditions, DuraSystems can provide a custom engineered solution to meet our customers needs.

# DuraBarrier™

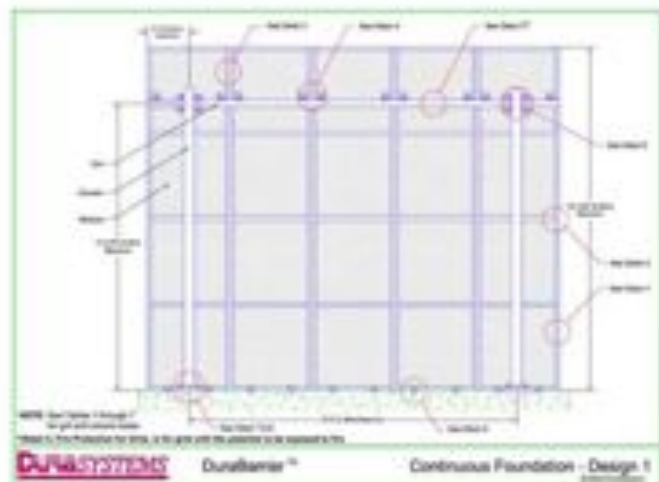

**Typical Multi-Module Two Column  
Barrier With Continuous Foundation**



**Typical Multiple Module and Column  
Barrier With Continuous Foundation**

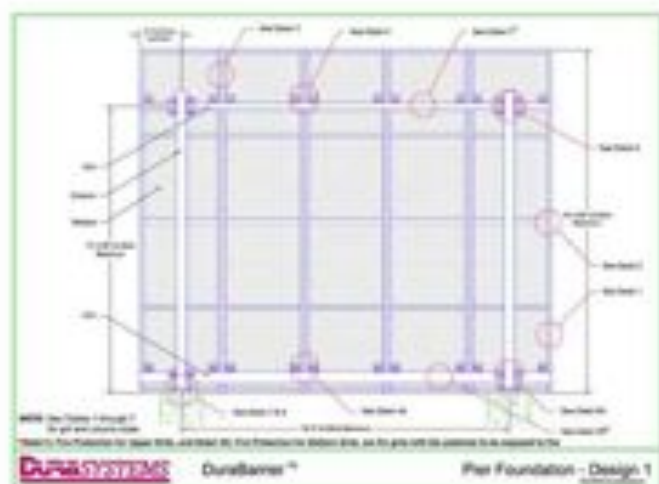

**Typical Multi-Module Two Column  
Barrier With Pier Foundation**

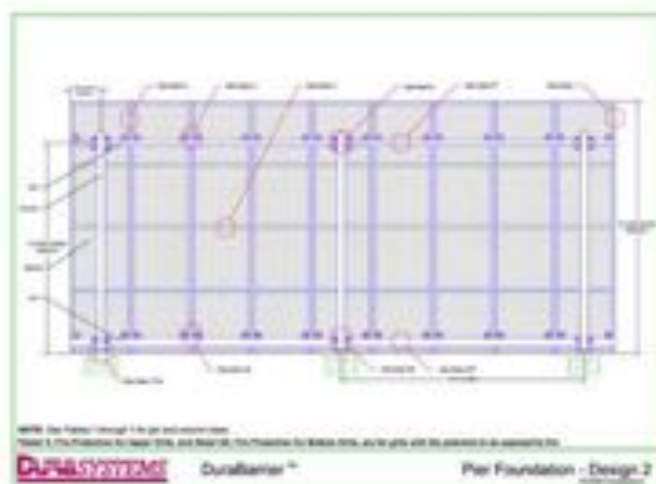

**Typical Multiple Module and Column  
Barrier With Pier Foundation**